



ENGINEERED COMMERCIAL
ROOF EDGE SYSTEMS



ARCHITECTURAL · COMMERCIAL · RESTORATION/CUSTOM

COPING AND PERIMETER ROOFING SYSTEMS

Selecting Your Perfect Perimeter Edge System



- A quality roof edge system will resist the pull of the roof material inwardly toward the center field of the roof.
- A quality roof edge system will resist the outward and upward forces which tend to blow or peel edge systems off a building.

Fact: Roof edge systems typically represent only about 1% of a building's overall cost. Yet, the importance of a properly designed roof edge system cannot be underestimated or ignored, as 60% of all roof warranty claims are attributed to metal edge failures.

What is an ES-1 Rated Roof Edge System?

It makes sense to specify and install only ES-1 and GT-1 Rated Roof Edge Systems.

ES-1 is a reference for those who design, specify, fabricate or install low slop roof edges. It's based upon the information in ASCE 7 Minimum Design Loads for Buildings and Other Structures. ANSI/SPRI ES-1 provides a calculation and test methods for determining wind uplift pressures on perimeter roof edge terminations – which means, your roof meets the highest quality standards.



ES-1/GT-1 Compliant and Tested

From the highest wind resistance to lighter duty, our perimeter systems have

you covered. Drexel Metals perimeter edge-to-edge, and ES-1 compliant edge metal systems and GT-1 compliant gutter systems are built weather-tough with premium quality, heavy-gauge materials and fully supporting engineered cleats that will meet the strictest of standards. The engineered cleats are manufactured in continuous and segmented lengths and are pre-punched, taking the guesswork out of cleat spacing. This unique design prevents sag and supports the coping for a markedly superior installation that's also quick and easy. Our products are precision-engineered to provide maximum wind resistance and eliminate roof edge blow off.



Drexel Metals Edge Systems are also available with continuous engineered cleats and a variety of gauges and design options.

- Coping widths of 4" to 32"
- Face dimensions of 4" to 12"
- Extruded Cleat



CONTENTS

Page 4:

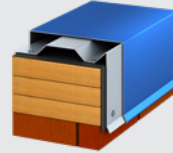

Snap Coping-Max

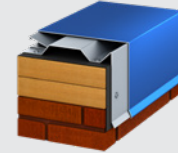

Snap Coping-Max-C

Page 5:

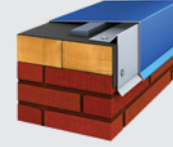

Econo Coping LT

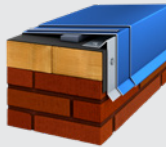

Econo Coping

Page 6:



Fascia LT



Secure Lok Fascia

Page 7:



Fascia Extender



Fascia Extender
w/Offset

Page 8:



Gravel Stop



Econo Gravel Stop

Page 9:

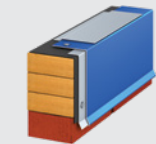

Drip Edge LT

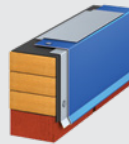

Drip Edge

Page 10:

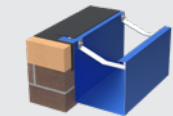

Gutter LT

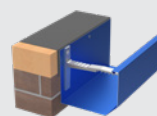

Gutter

COPING SYSTEMS

Engineered Commercial Roof Edge Systems

Snap Coping-Max – performance series:



Snap Coping-Max System is an assembly that includes a segmented cleat and a decorative snap-on coping cover for single-ply roofs. (Concealed splice plates and fasteners included.) Allows for installing fasteners vertically only (up to 6" face).

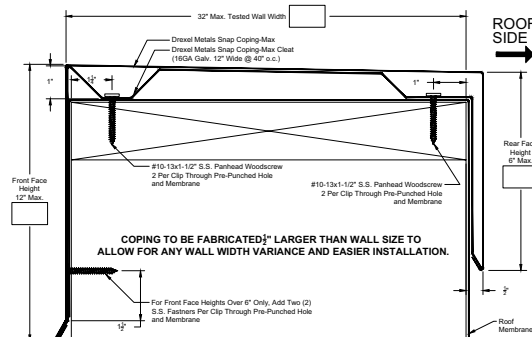

Features:

- Outside face: testing up to 12"
- Inside face: testing up to 6"
- 16ga segmented at 40" o.c. prepunched cleat
- Coping width: up to 32"

Material: 22ga, 24ga Steel
.040, .050, .063 Aluminum

Paint Warranty:

35-Year Non Pro-rated Gold Standard Paint Finish Warranty

Testing: Tested in accordance with ANSI/SPRI/FM4435/ES-I Test Standard For Edge Systems Used With Low Slope Roofing Systems to comply with the International Building Code. (Qualifies for 20-Year 90 mph Warranty)

Wall Width	Tested With	Sustained Pressure
Up to 32"	24 Gauge	-75
Up to 32"	.040 Alum.	-75

Snap Coping-Max-C – high performance series:

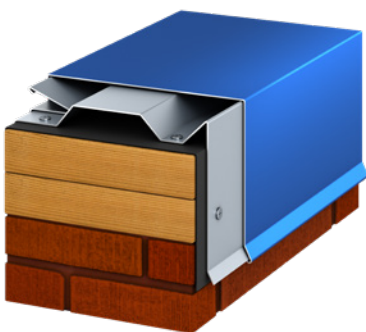

Snap Coping-Max-C System is an assembly that includes a segmented cleat, a spring clip, and a decorative snap-on coping cover for single-ply roofs. (Concealed splice plates and fasteners included.) Allows for installing fasteners vertically only (up to 6" face).

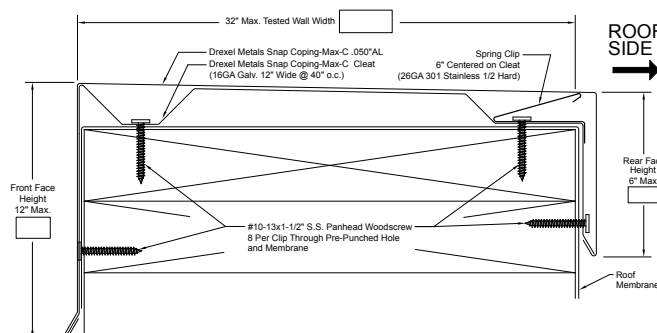

Features:

- Outside face: testing up to 12"
- Inside face: testing up to 6"
- 16ga segmented at 20" or 40" o.c. pre-punched cleat
- Coping width: up to 32"

Material: 22ga, 24ga Steel
.040, .050, .063 Aluminum

Paint Warranty:

35-Year Non Pro-rated Gold Standard Paint Finish Warranty

Testing: Tested in accordance with ANSI/SPRI/FM4435/ES-I Test Standard For Edge Systems Used With Low Slope Roofing Systems to comply with the International Building Code. (Qualifies for 20-Year 90 mph Warranty)

Wall Width	Tested With	Sustained Pressure
Up to 24"	24 Gauge	-170
Up to 24"	.040 Alum.	-180
Up to 32"	.050 Alum.	-155

ECONO COPING SYSTEMS

Engineered Commercial Roof Edge Systems

Econo Copping LT – performance series:

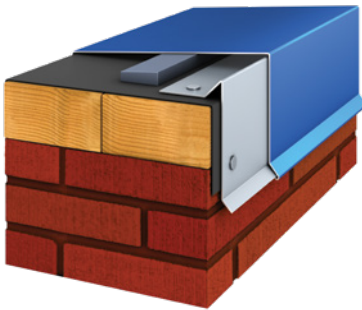

Econo Copping LT System is a two-part assembly that includes a continuous cleat and a decorative snap-on coping cover for single-ply roofs. (Concealed splice plates and fasteners included.)

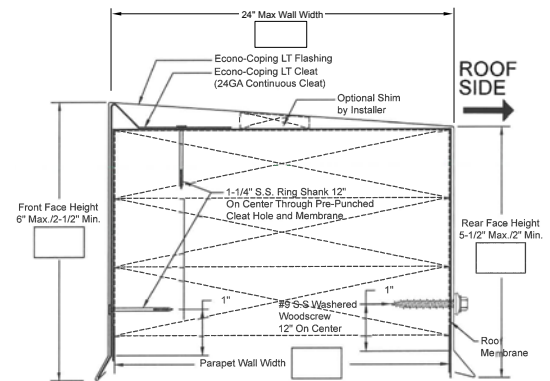

Features:

- Outside face: testing up to 6"
- Inside face: testing up to 5.5"
- 24ga continuous cleat
- Copping width: up to 24"

Material: 22ga, 24ga Steel
.040, .050, .063 Aluminum

Paint Warranty:

35-Year Non Pro-rated Gold Standard Paint Finish Warranty

Testing: Tested in accordance with ANSI/SPRI/FM4435/ES-1 Test Standard For Edge Systems Used With Low Slope Roofing Systems to comply with the International Building Code. (Qualifies for 20-Year 90 mph Warranty)

Wall Width	Tested With	Sustained Pressure
Up to 16"	24 Gauge	-110
Up to 20"	24 Gauge	-85
Up to 16"	.040 Alum.	-115
Up to 20"	.040 Alum.	-85

Econo Copping – high performance series:

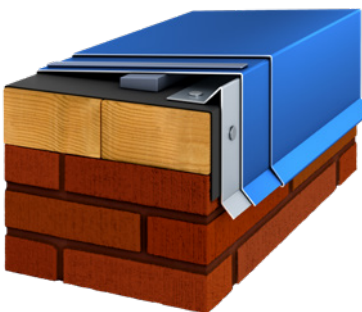

Econo Copping System is a two-part assembly that includes a continuous cleat and a decorative snap-on coping cover for single-ply roofs. (Concealed splice plates and fasteners included.)

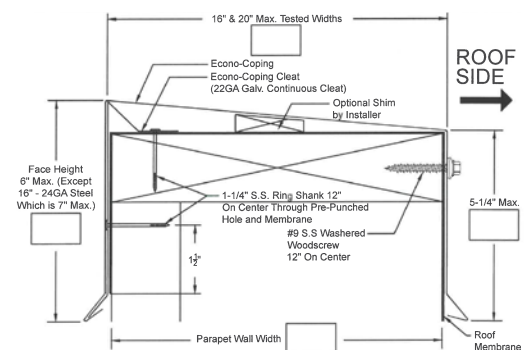

Features:

- Outside face: testing up to 6"
- Inside face: testing up to 5.25"
- 22ga continuous cleat
- Copping width: up to 20"

Material: 22ga, 24ga Steel
.040, .050, .063 Aluminum

Paint Warranty:

35-Year Non Pro-rated Gold Standard Paint Finish Warranty

Testing: Tested in accordance with ANSI/SPRI/FM4435/ES-1 Test Standard For Edge Systems Used With Low Slope Roofing Systems to comply with the International Building Code. (Qualifies for 20-Year 90 mph Warranty)

Wall Width	Tested With	Sustained Pressure
Up to 16"	24 Gauge	-110
Up to 20"	24 Gauge	-75
Up to 16"	.040 Alum.	-145
Up to 20"	.040 Alum.	-65

FASCIA SYSTEMS

Engineered Commercial Roof Edge Systems

Fascia LT – performance series:

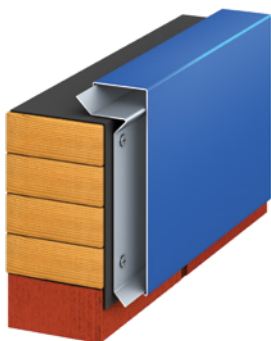

Fascia LT System is a two-part assembly that includes a continuous base and a decorative snap-on fascia cover for single-ply roofs. (Concealed splice plates and fasteners are included.)

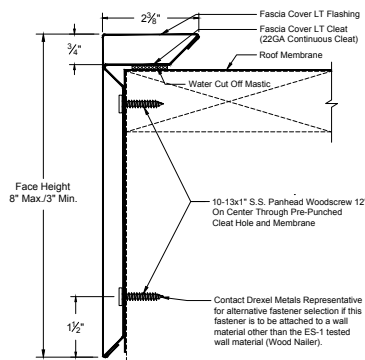

Features:

- Outside face: testing up to 8"
- 22ga continuous cleat

Material: 22ga, 24ga Steel
.040, .050, .063 Aluminum

Paint Warranty:

35-Year Non Pro-rated Gold Standard Paint Finish Warranty

Testing: Tested in accordance with ANSI/SPRI/FM4435/ES-1 Test Standard For Edge Systems Used With Low Slope Roofing Systems to comply with the International Building Code. (Qualifies for 20-Year 90 mph Warranty)

Face Height	Tested With	Sustained Pressure
Up to 8"	24 Gauge	-210
Up to 8"	.040 Alum.	-180

Secure Lok – performance series:



Secure Lok Fascia System is a three-part assembly that includes a continuous cleat, 6" spring clip and a decorative fascia cover for single-ply commercial roof systems. (Concealed cleat, splice plates and fasteners included.)

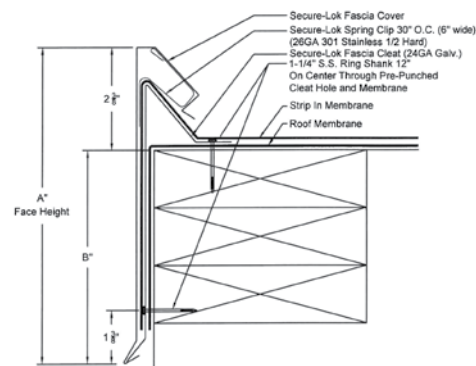

Features:

- Outside face: testing up to 12.75"
- 24ga continuous cleat

Material: 22ga, 24ga Steel
.040, .050, .063 Aluminum

Paint Warranty: 35-Year Non Pro-rated Gold Standard Paint Finish Warranty

Testing Text: Tested in accordance with ANSI/SPRI/FM4435/ES-1 Test Standard For Edge Systems Used With Low Slope Roofing Systems to comply with the International Building Code. (Qualifies for 20-Year 90 mph Warranty)

Wall Width	Tested With	Sustained Pressure
Up to 8.25"	24 Gauge	-210
Up to 8.25"	.040 Alum.	-170
Up to 12.75"	22 Gauge	-150
Up to 12.75"	24 Gauge	-100
Up to 12.75"	.050 Alum.	-220

FASCIA EXTENDER SYSTEMS

Engineered Commercial Roof Edge Systems

Fascia Extender – performance series:



Fascia Extender is a two-part assembly that includes a continuous cleat and a decorative fascia cover for single-ply commercial roof systems. It extends the face of the fascia for longer stretch that helps meet design without sacrificing tested sizes. (Concealed splice plates and fasteners included.)

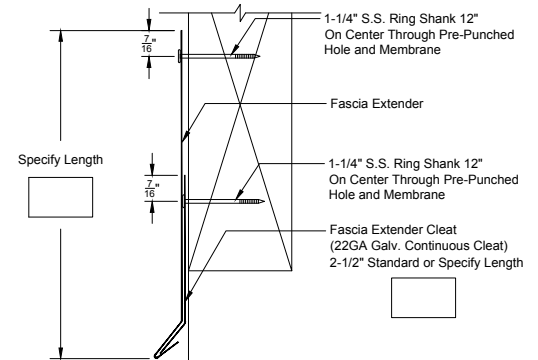

Features:

- 22ga continuous cleat

Material: 22ga, 24ga Steel
.032, .040, .050, .063 Aluminum

Paint Warranty:

35-Year Non Pro-rated Gold Standard Paint Finish Warranty

Testing: Tested in accordance with ANSI/SPRI/FM4435/ES-1 Test Standard For Edge Systems Used With Low Slope Roofing Systems to comply with the International Building Code. (Qualifies for 20-Year 90 mph Warranty)

Fascia Extender W/Offset – performance series:



Fascia Extender w/Offset is a two-part assembly that includes a continuous cleat and a decorative fascia cover for single-ply commercial roof systems. It extends the face of the fascia for longer stretch that helps meet design without sacrificing tested sizes. (Concealed splice plates and fasteners included.)

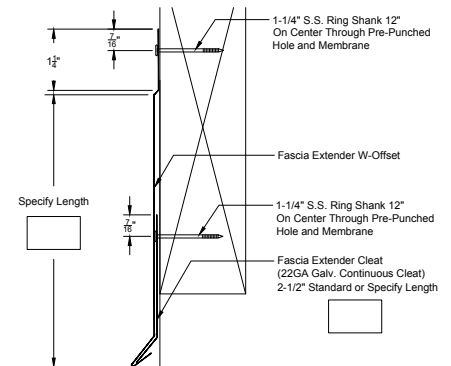

Features:

- 22ga continuous cleat

Material: 22ga, 24ga Steel
.032, .040, .050, .063 Aluminum

Paint Warranty:

35-Year Non Pro-rated Gold Standard Paint Finish Warranty

Testing: Tested in accordance with ANSI/SPRI/FM4435/ES-1 Test Standard For Edge Systems Used With Low Slope Roofing Systems to comply with the International Building Code. (Qualifies for 20-Year 90 mph Warranty)

GRAVEL STOP SYSTEMS

Engineered Commercial Roof Edge Systems

Gravel Stop – performance series:



Gravel Stop System is built weather-tough with heavy-gauge materials and a fully supporting engineered cleat that will meet the strictest of standards. (Concealed splice cleat, splice plates and fasteners included.)

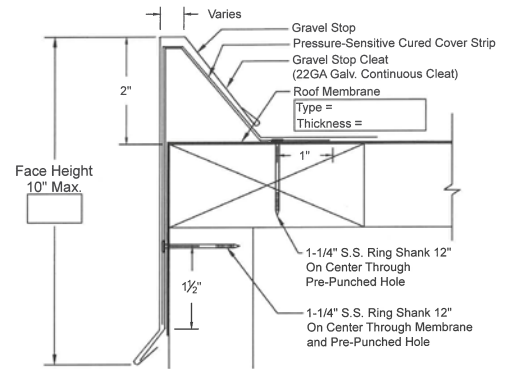

Features:

- Outside face: testing up to 10"
- 22ga continuous cleat

Material: 22ga, 24ga Steel
.040, .050, .063 Aluminum

Paint Warranty:

35-Year Non Pro-rated Gold Standard
Paint Finish Warranty

Testing: Tested in accordance with
ANSI/SPRI/FM4435/ES-1 Test
Standard For Edge Systems Used With
Low Slope Roofing Systems to comply
with the International Building Code.
(Qualifies for 20-Year 90 mph Warranty)

Face Height	Tested With	Sustained Pressure
Up to 10"	24 Gauge	-140
Up to 10"	.040 Alum.	-130

Econo Gravel Stop – high performance series:



Gravel Stop two-part assembly includes a pre-punched continuous cleat and a decorative fascia cover, providing a seamless and professional finish to your building's exterior. (Concealed splice plates and fasteners included.)

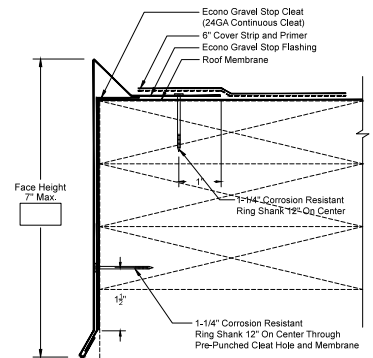

Features:

- Outside face: testing up to 7"
- 24ga continuous cleat

Material: 22ga, 24ga Steel
.040, .050, .063 Aluminum

Paint Warranty:

35-Year on Pro-rated Gold Standard
Paint Finish Warranty

Testing Text: Tested in accordance
with ANSI/SPRI/FM4435/ES-1 Test
Standard For Edge Systems Used With
Low Slope Roofing Systems to comply
with the International Building Code.
(Qualifies for 20-year 90 mph Warranty)

Face Height	Tested With	Sustained Pressure
Up to 7"	24 Gauge	-70
Up to 7"	.040 Alum.	-90

DRIP EDGE SYSTEMS

Engineered Commercial Roof Edge Systems

Drip Edge LT – performance series:

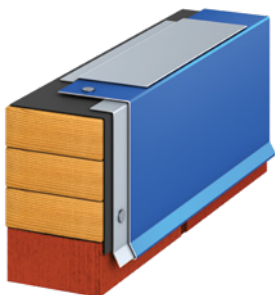

Drip Edge LT System is a two-part assembly that includes a continuous base and a decorative drip edge cover for single-ply roofs. (Concealed splice plates and fasteners included.)

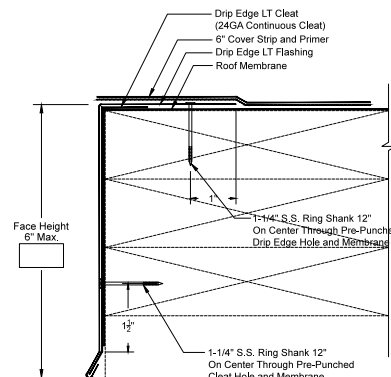

Features:

- Outside face: testing up to 6"
- 24ga continuous cleat

Material: 22ga, 24ga Steel
.040, .050, .063 Aluminum

Paint Warranty:

35-Year Non Pro-rated Gold Standard
Paint Finish Warranty

Testing: Tested in accordance with
ANSI/SPRI/FM4435/ES-1 Test
Standard For Edge Systems Used With
Low Slope Roofing Systems to comply
with the International Building Code.
(Qualifies for 20-Year 90 mph Warranty)

Face Height	Tested With	Sustained Pressure
Up to 6"	24 Gauge	-240
Up to 6"	.040 Alum.	-250

Drip Edge – high performance series:

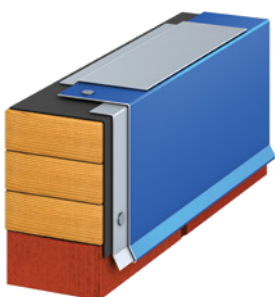

Drip Edge System is a two-part assembly that includes a continuous base and a decorative drip edge cover for single-ply roofs. (Concealed splice plates and fasteners included.)

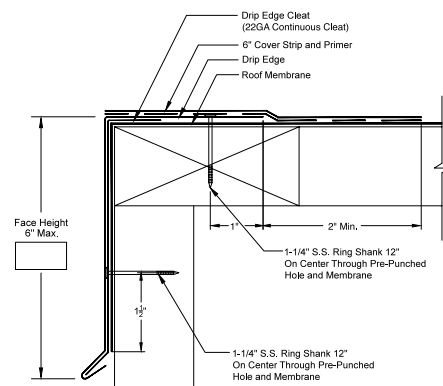

Features:

- Outside face: testing up to 6"
- 22ga continuous cleat

Material: 22ga, 24ga Steel
.040, .050, .063 Aluminum

Paint Warranty:

35-Year Non Pro-rated Gold Standard
Paint Finish Warranty

Testing: Tested in accordance with
ANSI/SPRI/FM4435/ES-1 Test
Standard For Edge Systems Used With
Low Slope Roofing Systems to comply
with the International Building Code.
(Qualifies for 20-Year 90 mph Warranty)

Face Height	Tested With	Sustained Pressure
Up to 6"	24 Gauge	-175
Up to 6"	.040 Alum.	-185

WATER CONTROL SYSTEMS

Engineered Commercial Roof Edge Systems

Gutter LT

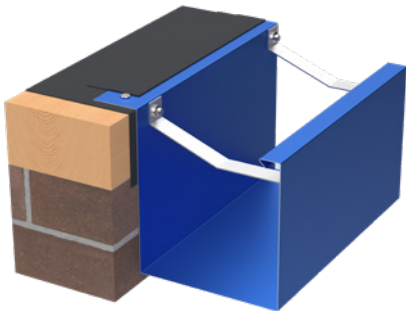

Designed for single-ply roofs, the Gutter LT System features a durable, hot-dipped galvanized steel internal gutter bracket for reliable, long-lasting performance. (Gutter brackets and fasteners included)

Profiles: Box, Chamfer

Material: 22ga, 24ga Steel .040, .050, .063 Aluminum

Paint Warranty: 35-Year Non Pro-rated Gold Standard Paint Finish Warranty

Testing: Tested in accordance with ANSI/SPRI GT-1 Test Standard For External Gutter Systems to comply with the International Building Code. (Qualifies for 20-year 90 mph Warranty)

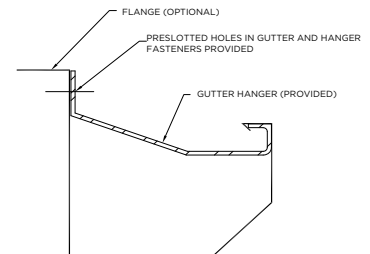

Gutter Type	Tested With	Sustained Pressure
G-1 Horizontal	24 Gauge	-150
G-2 Vertical	24 Gauge	-52.5

Gutter Type	Tested With	Sustained Pressure
G-1 Horizontal	.040 Alum.	-150
G-2 Vertical	.040 Alum.	-52.5

Gutter

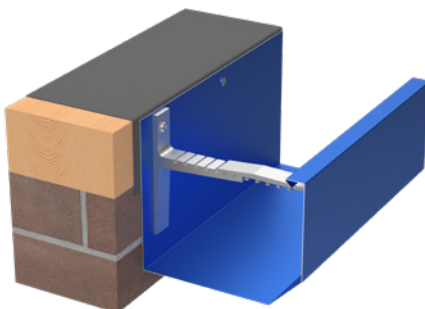

Gutter System is a heavy-duty gutter system used with single-ply roofs. Made from high-strength extruded aluminum, the internal gutter bracket provides long-lasting protection against corrosion and extreme weather conditions. (Gutter brackets and fasteners included)

Profiles: Box, Chamfer, Offset

Material: 22ga, 24ga Steel .040, .050, .063 Aluminum

Paint Warranty: 35-Year Non Pro-rated Gold Standard Paint Finish Warranty

Testing: Tested in accordance with ANSI/SPRI GT-1 Test Standard For External Gutter Systems to comply with the International Building Code. (Qualifies for 20-year 90 mph Warranty)

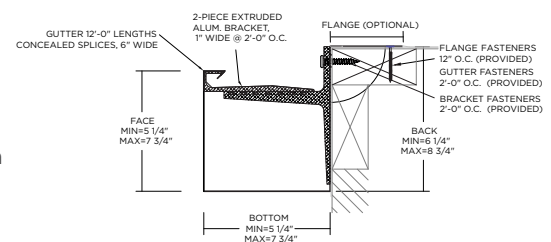

Gutter Type	Tested With	Sustained Pressure
G-1 Horizontal	24 Gauge	-220
G-2 Vertical	24 Gauge	-90

Gutter Type	Tested With	Sustained Pressure
G-1 Horizontal	.040 Alum.	-220
G-2 Vertical	.040 Alum.	-90

Engineered Commercial Roof Edge Systems



ES-1 Tested Perimeter Edge Systems Wind Warranty.

ensure installed products meet or exceed the most stringent code requirements in the country.

Standard (Edge) Wind Warranty: Drexel Metals provides customers with peace of mind with industry-leading coverage against strong winds.

- **90 mph 20-Year (Edge) Wind Warranty:** A 20-year warranty which provides increased wind protection.

For complete information about warranty options, please call your Drexel Metals representative. It's also recommended to **check with your single-ply manufacturer for actual wind speed results of your roof membrane system.**

Drexel Metals
ES-1 Certified
Perimeter
Edge Systems
Wind
Warranty

(From date of installation)



Drexel Metals
Roofing Systems + Custom Fabrication



